

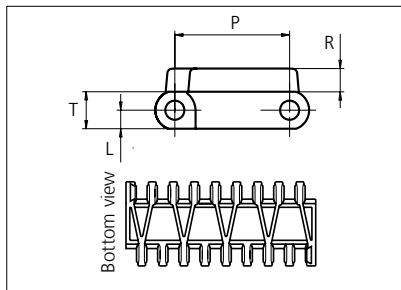

Plastic Modular Belt

Serie **uni OPB 4V** Type **23% Rib**

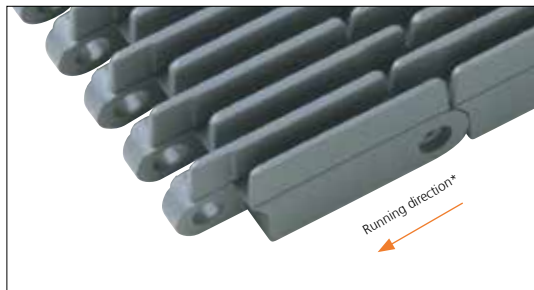

Straight running belt
 Nominal pitch: 50.0 mm (1.97 in)
 Surface type: Rib Top
 Surface opening: 23%
 Backflex radius: 300.0 mm (11.80 in)
 Pin diameter: 8.0 mm (1.97 in)

*uni-chains recommends this travel direction. However, travel in both directions is possible.

Note: uni OPB 36% 4V are listed in the USDA "Accepted Meat and Poultry Equipment" publication as accepted food contact.

Belt material & color	PP-HW LB	PP G	mm	in	P (Nominal)	mm	in			
			T	16.0		0.63	50.0	1.97		
Pin and lock material & color	PP-HW LB	PP W	mm	in	R	L	8.0	0.31	10.0	0.39

Non standard material and color: See uni Material and Color Overview.

Alternative pin and lock materials: Trilock: PP-HW **LB** Endlock: PP **W G B** PE **W B** Lockpin: PP **W** PE **W** PA6.6 **N B** PBT **LG**
 Pin: PP **W** PE **W** PBT **LG** SS304 and SS316

Belt width		Permissible tensile force (Belt/pin material)				Belt weight (Belt/pin material)				*Min. No. drive sprocket per shaft	Number of wear strips (Min. No.)	
		PP-HW/PP-HW		PP/PP-HW		PP-HW/PP-HW		PP/PP-HW			**Carry (pcs)	**Return (pcs)
mm	in	N	lbf	N	lbf	kg/m	lb/ft	kg/m	lb/ft			
151	5.9	1661	373	1661	373	1.0	0.69	1.0	0.69	2	2	2
302	11.9	3322	747	3322	747	2.1	1.38	2.1	1.38	3	3	2
453	17.8	4983	1120	4983	1120	3.1	2.07	3.1	2.07	4	4	2
604	23.8	6644	1494	6644	1494	4.1	2.76	4.1	2.76	5	5	3
755	29.7	8305	1867	8305	1867	5.1	3.45	5.1	3.45	6	6	3
906	35.7	9966	2240	9966	2240	6.2	4.14	6.2	4.14	7	7	4
1057	41.6	11627	2614	11627	2614	7.2	4.83	7.2	4.83	8	8	4
1208	47.6	13288	2987	13288	2987	8.2	5.52	8.2	5.52	9	9	5
1359	53.5	14949	3361	14949	3361	9.2	6.21	9.2	6.21	10	10	5
1510	59.4	16610	3734	16610	3734	10.3	6.90	10.3	6.90	11	11	6
1661	65.4	18271	4107	18271	4107	11.3	7.59	11.3	7.59	12	12	6
1812	71.3	19932	4481	19932	4481	12.3	8.28	12.3	8.28	13	13	7

Additional standard belt widths are available in steps of 151.0 mm (5.94 in). Additional non-standard belt widths are available in steps of 33.6 mm (1.32 in).

2567	101.1	28237	6348	28237	6348	17.5	11.73	17.5	11.73	18	18	9
------	-------	-------	------	-------	------	------	-------	------	-------	----	----	---

Additional standard belt widths are available in steps of 151.0 mm (5.94 in). Additional non-standard belt widths are available in steps of 33.6 mm (1.32 in).

2869	113.0	31559	7094	31559	7094	19.5	13.11	19.5	13.11	20	20	10
------	-------	-------	------	-------	------	------	-------	------	-------	----	----	----

General belt tolerance is +0/-0.4% at 23°C/73°F and 50% RH. For exact belt width contact Customer Service. Non standard belt width on request.

*Max. Load per Drive Sprocket. Belt material: POM 2500 N (562 lbf), PP 1200 N (270 lbf), PE 500 N (270 lbf)

**Max. Spacing between wear strips, Carry: 152.0 mm (6.00 in); Return: 304.0 mm (12.00 in).

= Single Link



STANDARD

STRAIGHT RUNNING

PITCH 50.0 MM/1.97 IN

Accessories

Finger Plates

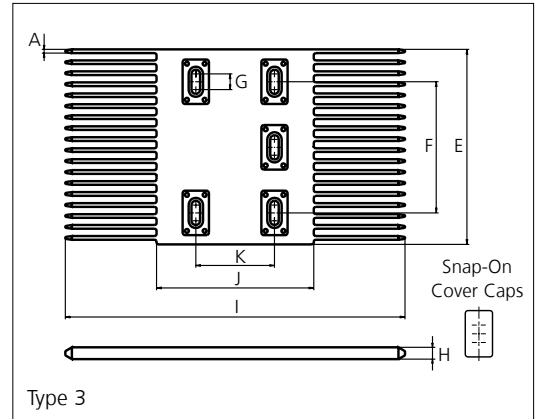
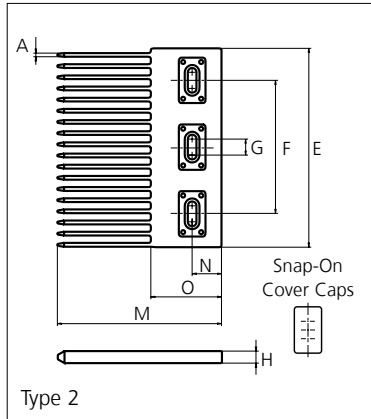
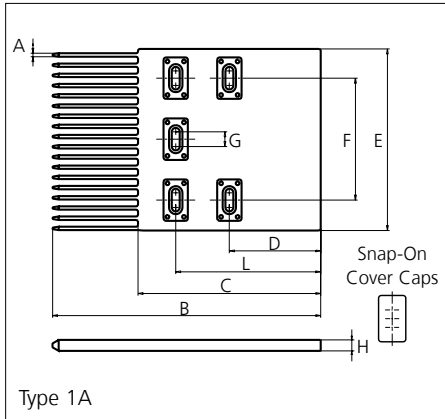

Type	Material & color	A		B		C		D		E		F	
		mm	in	mm	in	mm	in	mm	in	mm	in	mm	in
Single Sided	POM-DI G	2.8	0.11	220.0	8.66	150.0	5.91	75.0	2.95	149.0	5.87	100.0	3.94
Double Sided													

G		H		I		J		K		L		M		N		O	
mm	in	mm	in	mm	in	mm	in	mm	in	mm	in	mm	in	mm	in	mm	in
12.0	0.47	9.0	0.35	259.0	10.20	120.0	4.72	60.0	2.36	119.0	4.69	123.0	4.84	22.0	0.87	53.0	2.09

All uni-chains belt systems are available in a raised rib version that can be supplied with matching finger plates, also called combs.

The finger plates are supplied with cover caps which can be attached when the finger plate has been installed. The cover caps can be removed by using a screwdriver that can be inserted between the cover and finger plate. In order to adjust to belt width variations caused by temperature fluctuations, a slider facilitates the sideways movement of the finger plates.

Non Standard material and color: See uni Material and Color Overview.

Sprocket

No of teeth	Bore size													Overall diameter		Pitch-diameter		Hub-diameter		Dimension A		Dimension B		Single row/Two way	Double row/Two way	Machined									
	Pilot Bore																									Molded	PA6 LG								
	mm	in	19.1	0.75	0.78	0.98	1.00	1.18	1.25	1.50	1.57	2.36	2.50	3.54	60.0	63.5	90.0	mm	in	mm	in	mm	in	mm	in	mm	in	mm	in	mm	in	mm	in	mm	in
Z06	x					●	●	●	■	■							94.5	3.72	100.3	3.95	65	2.56	35.5	1.40	58.6	2.31	x		x						
Z08	x					●	●	●	■	■							129	5.08	131.1	5.16	65	2.56	52.6	2.07	74	2.91	x		x						
Z10	x						●	●	■	■							160.1	6.30	162.4	6.39	65	2.56	69.2	2.72	89.7	3.53	x		x						
Z12	x						●	●	■	■							191.5	7.54	193.9	7.63	65	2.56	85.7	3.37	105.5	4.15	x		x						
Z13	x						●		■	■							207.3	8.16	209.7	8.26	72	2.83	93.8	3.69	113.4	4.46	x		x						
Z13														■			207.3	8.16	209.7	8.26	150	5.91	93.8	3.69	113.4	4.46	x							x	
Z16	x						●		■	■				■			254.8	10.03	257.3	10.13	200	7.87	118.2	4.65	137.1	5.40	x							x	

■ Molded sprocket

● Molded sprocket

■ Machined sprocket

● Machined sprocket

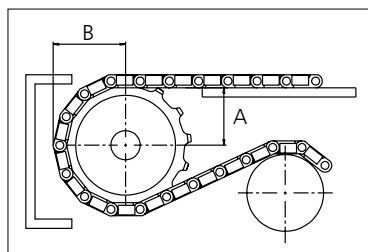
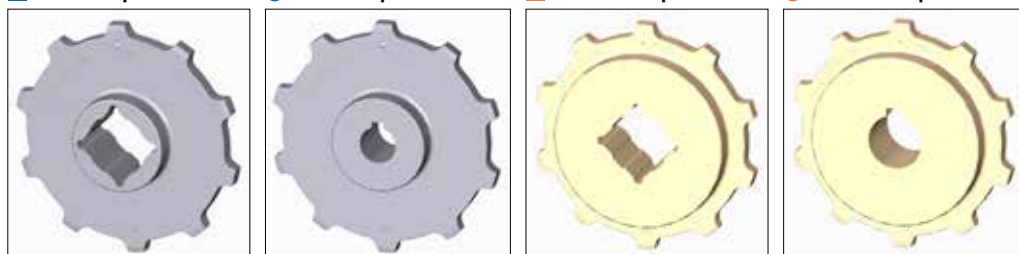

Other sprocket sizes are available upon request.
 Two-part sprocket are available upon request.
 Round bores are always delivered with keyway.
 Other bore sizes are available upon request.
 uni Retainer Rings: See uni Retainer Ring data sheet
 Width of tooth = 11.0 mm (0.43 in)
 Width of sprocket = 42.3 mm (1.67 in)

Max load per sprocket shown does not take bore size into account.
 Please also ensure that sufficient size shaft is chosen for corresponding load.

For correct sprocket position: See uni Assembly Instructions for uni OPB.
 For more detailed sprocket information, contact Customer Service.

Non standard material and color: See uni Material and Color Overview.



Conveyor Belts



Seamless Belts



Modular Belts



Timing Belts



Transmission Belts



Fabrication & service

Expert advice, quality solutions
and local service
for all your belting needs
www.ammeraalbeltech.com

Ammeraal Beltech Modular A/S
Hjulmagervej 21
DK-7100 Vejle

T +45 7572 3100
F +45 7572 3348
admin@unichains.com
www.unichains.com

This information is subject to alteration due to continuous development. Ammeraal Beltech will not be held liable for the incorrect use of the above stated information. This information replaces previous information. All activities performed and services rendered by Ammeraal Beltech are subject to general terms and conditions of sale and delivery, as applied by its operating companies.