

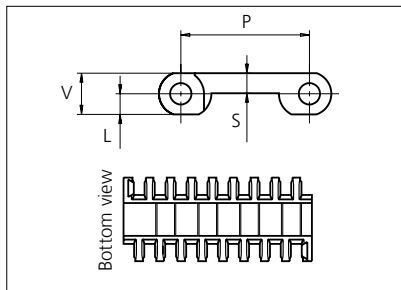

Plastic Modular Belt

Series **uni OPB 8** Type **C**



Straight running belt
 Nominal pitch: 50.0 mm (1.97 in)
 Surface type: Flat
 Surface opening: Closed
 Backflex radius: 75.0 mm (3.00 in)
 Pin diameter: 8 mm (1.97 in)

*uni-chains recommends this travel direction. However, travel in both directions is possible.

| | | | | | | | |
|---|----------------|--------------------|------|------|----------|------|------|
| Recommended belt material & color | POM-D W | | mm | in | | mm | in |
| | | P (Nominal) | 50.0 | 1.97 | V | 16.0 | 0.63 |
| Recommended pin and lock material & color | PP W | | | | | | |
| | | L | 8.0 | 0.31 | S | 7.8 | 0.31 |

Non standard material and color: See uni Material and Color Overview.

Alternative materials: Belt: POM-LF, POM-SLF, PP, PE, PA6.6 and PA6.6H Rodlock: PP **W** Endlock: PP **W G B** and PE **W B**
 Lockpin: PE **W** PA6.6 **N** PP **W** Pin: PP **W** PE **W** SS304 and SS316

| Belt width | | Permissible tensile force (Belt/pin material) | | | | | | Belt weight (Belt/pin material) | | | | | | *Min. No. drive sprocket per shaft | Number of wear strips (Min. No.) | |
|------------|------|---|------|----------|------|----------|------|---------------------------------|-------|----------|-------|----------|-------|------------------------------------|----------------------------------|----------------|
| | | POM-D/PA6.6 | | PP/PA6.6 | | PE/PA6.6 | | POM-D/PA6.6 | | PP/PA6.6 | | PE/PA6.6 | | | **Carry (pcs) | **Return (pcs) |
| mm | in | N | lbf | N | lbf | N | lbf | kg/m | lb/ft | kg/m | lb/ft | kg/m | lb/ft | | | |
| 118 | 4.6 | 2596 | 584 | 1298 | 292 | 779 | 175 | 1.3 | 0.89 | 0.9 | 0.59 | 1.0 | 0.64 | 2 | 2 | 2 |
| 151 | 5.9 | 3322 | 747 | 1661 | 373 | 997 | 224 | 1.7 | 1.14 | 1.1 | 0.76 | 1.2 | 0.82 | 2 | 2 | 2 |
| 185 | 7.3 | 4070 | 915 | 2035 | 457 | 1221 | 274 | 2.1 | 1.39 | 1.4 | 0.93 | 1.5 | 1.01 | 2 | 2 | 2 |
| 302 | 11.9 | 6644 | 1494 | 3322 | 747 | 1993 | 448 | 3.4 | 2.27 | 2.3 | 1.52 | 2.4 | 1.64 | 3 | 3 | 2 |
| 453 | 17.8 | 9966 | 2240 | 4983 | 1120 | 2990 | 672 | 5.1 | 3.41 | 3.4 | 2.28 | 3.7 | 2.47 | 4 | 4 | 2 |
| 604 | 23.8 | 13288 | 2987 | 6644 | 1494 | 3986 | 896 | 6.8 | 4.55 | 4.5 | 3.04 | 4.9 | 3.29 | 5 | 5 | 3 |
| 755 | 29.7 | 16610 | 3734 | 8305 | 1867 | 4983 | 1120 | 8.5 | 5.68 | 5.7 | 3.81 | 6.1 | 4.11 | 6 | 6 | 3 |
| 906 | 35.7 | 19932 | 4481 | 9966 | 2240 | 5980 | 1344 | 10.1 | 6.82 | 6.8 | 4.57 | 7.3 | 4.93 | 7 | 7 | 4 |
| 1057 | 41.6 | 23254 | 5227 | 11627 | 2614 | 6976 | 1568 | 11.8 | 7.96 | 7.9 | 5.33 | 8.6 | 5.75 | 8 | 8 | 4 |
| 1208 | 47.6 | 26576 | 5974 | 13288 | 2987 | 7973 | 1792 | 13.5 | 9.09 | 9.1 | 6.09 | 9.8 | 6.58 | 9 | 9 | 5 |
| 1359 | 53.5 | 29898 | 6721 | 14949 | 3361 | 8969 | 2016 | 15.2 | 10.23 | 10.2 | 6.85 | 11.0 | 7.40 | 10 | 10 | 5 |
| 1510 | 59.4 | 33220 | 7468 | 16610 | 3734 | 9966 | 2240 | 16.9 | 11.37 | 11.3 | 7.61 | 12.2 | 8.22 | 11 | 11 | 6 |
| 1661 | 65.4 | 36542 | 8215 | 18271 | 4107 | 10963 | 2464 | 18.6 | 12.50 | 12.5 | 8.37 | 13.5 | 9.04 | 12 | 12 | 6 |

Additional standard belt widths are available in steps of 151.0 mm (5.94 in). Additional non-standard belt widths are available in steps of 33.6 mm (1.32 in).

| | | | | | | | | | | | | | | | | |
|------|-------|-------|-------|-------|------|-------|------|------|-------|------|-------|------|-------|----|----|---|
| 2567 | 101.1 | 56474 | 12695 | 28237 | 6348 | 16942 | 3809 | 28.8 | 19.32 | 19.3 | 12.94 | 20.8 | 13.97 | 18 | 18 | 9 |
|------|-------|-------|-------|-------|------|-------|------|------|-------|------|-------|------|-------|----|----|---|

Additional standard belt widths are available in steps of 151.0 mm (5.94 in). Additional non-standard belt widths are available in steps of 33.6 mm (1.32 in).

| | | | | | | | | | | | | | | | | |
|------|-------|-------|-------|-------|------|-------|------|------|-------|------|-------|------|-------|----|----|----|
| 2869 | 113.0 | 63118 | 14189 | 31559 | 7094 | 18935 | 4257 | 32.1 | 21.59 | 21.5 | 14.46 | 23.2 | 15.62 | 20 | 20 | 10 |
|------|-------|-------|-------|-------|------|-------|------|------|-------|------|-------|------|-------|----|----|----|

General belt tolerance is +0/-0.4% at 23°C/73°F and 50% RH. For exact belt width contact Customer Service. Non standard belt width on request.

*Max. Load per Drive Sprocket. Belt material: POM 2500 N (562 lbf), PP 1200 N (270 lbf), PE 500 N (270 lbf)

**Max. Spacing between wear strips, Carry: 152 mm (6 in); Return: 304 mm (12 in)

= Single Link



NON STANDARD

STRAIGHT RUNNING

PITCH 50.0 MM/1.97 IN

Accessories

Rubber Top

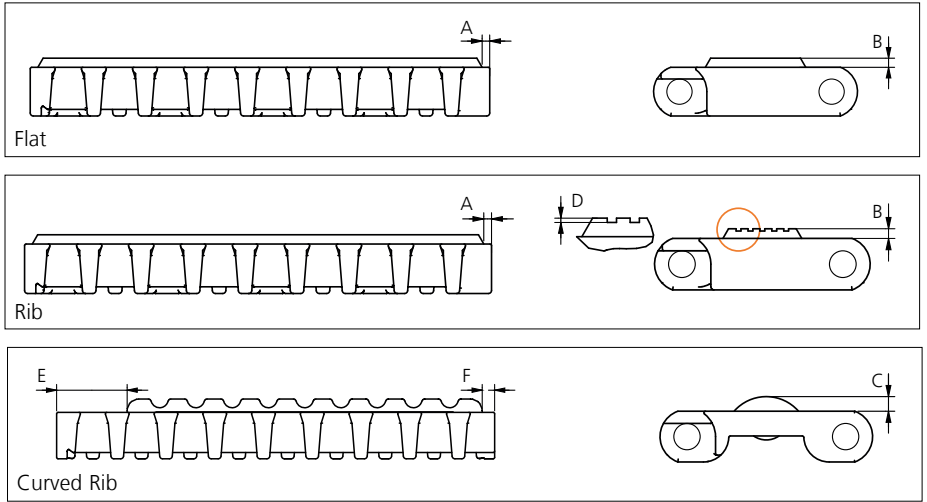

| Type | Belt Material & color | Rubber Material & color | A | | B | | C | | D | | E | | F | | Link size | Width | |
|------------|-----------------------|-------------------------|-----|------|-----|------|-----|------|-----|------|------|------|-----|------|-----------|-------|------|
| | | | mm | in | mm | in | mm | in | mm | in | mm | in | mm | in | | mm | in |
| Flat | POM-LF BR | 03 N | | | | | | | | | | | | | | | |
| Rib | POM-D W | | 2.5 | 0.10 | 3.0 | 0.12 | 4.5 | 0.18 | 0.7 | 0.03 | 24.0 | 0.94 | 4.0 | 0.16 | K600 | 150.5 | 5.93 |
| Curved Rib | POM-D W | 03 K | | | | | | | | | | | | | | | |

Other Non Standard Rubber profiles: See uni Rubber Profile Overview.

Accessories

Flight

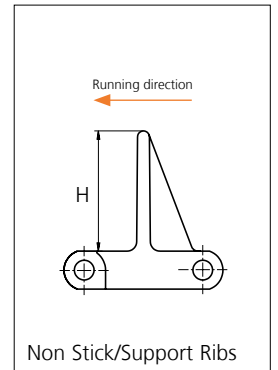
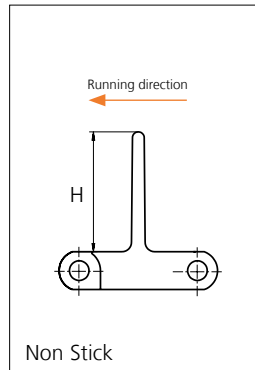

| Type | Recommended Material & color | H | | Link size | Width | | Indent | |
|--------------|------------------------------|-------|------|-----------|-------|------|--------|------|
| | | mm | in | | mm | in | mm | in |
| Non Stick | PP-HW B | 50.8 | 2.00 | K600 | 151.0 | 5.94 | 0.0 | 0.00 |
| Non Stick/ | | 76.2 | 3.00 | | | | | |
| Support Ribs | | 101.6 | 4.00 | | | | | |

Non Standard material and color: See uni Material and Color Overview.

Accessories

Side Guard

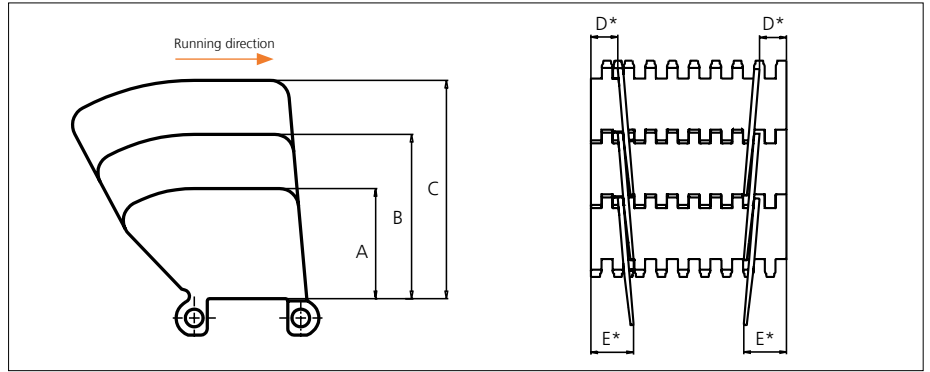

| Type | Recommended Material & color | A | | B | | C | | D* | | E* | |
|--------|------------------------------|------|------|------|------|-------|------|------|------|------|------|
| | | mm | in | mm | in | mm | in | mm | in | mm | in |
| Closed | PP-HW B | 51.8 | 2.04 | 77.2 | 3.04 | 102.6 | 4.04 | 21.0 | 0.83 | 34.0 | 1.34 |

* Min. indent Increment : 8.4 mm (0.33 in)

Note: Backflex radius when side guard are used: 200.0 mm (7.90 in)

Non Standard material and color: See uni Material and Color Overview.

Accessories

Tab

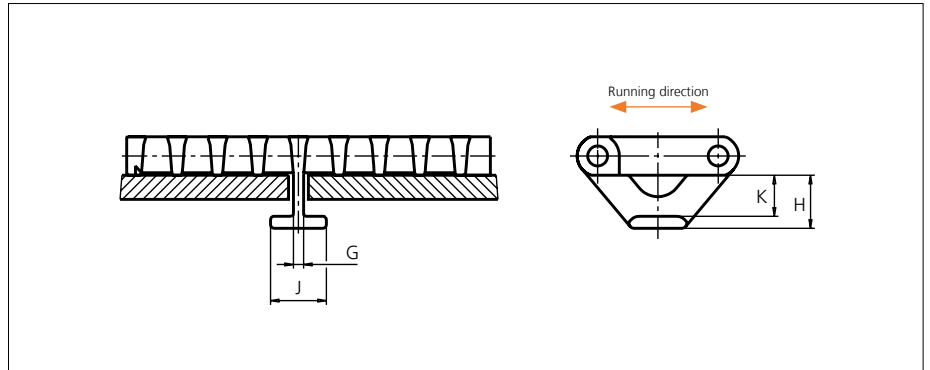

| Type | Recommended material & color | G | | H | | J | | K | |
|------------------|------------------------------|-----|------|------|------|------|------|------|------|
| | | mm | in | mm | in | mm | in | mm | in |
| Bottom Hold Down | POM-D N | 4.2 | 0.17 | 22.0 | 0.87 | 23.2 | 0.92 | 17.0 | 0.67 |
| | POM-LF B | | | | | | | | |
| | PP W | | | | | | | | |

Non Standard material and color: See uni Material and Color Overview.

Accessories

Non Standard uni AmFlight

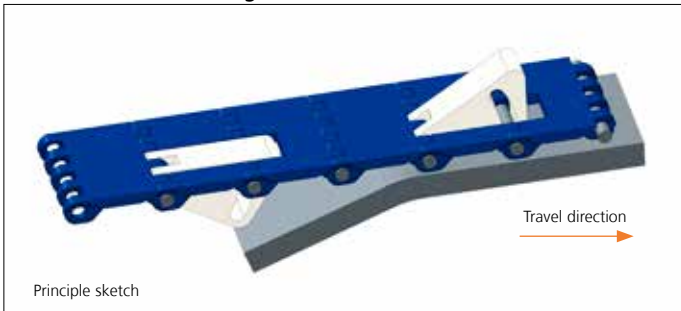

Other Non Standard option: See uni AmFlight Overview.

Sprocket

| No. of teeth | Bore size | | | | | | | | | | | | | Overall diameter | | Pitch-diameter | | Hub-diameter | | Dimension A | | Dimension B | | Single row/Two way | Double row/Two way | Molded PA6 LG | Machined PA6 N |
|--------------|------------|------|------|------|------|------|------|------|------|------|------|------|-------|------------------|-------|----------------|-----|--------------|-------|-------------|-------|-------------|---|--------------------|--------------------|---------------|----------------|
| | Pilot Bore | in | 0.75 | 0.78 | 0.98 | 1.00 | 1.18 | 1.25 | 1.50 | 1.57 | 2.36 | 2.50 | 3.54 | | | | | | | | | | | | | | |
| | mm | 19.1 | 20.0 | 25.0 | 25.4 | 30.0 | 31.8 | 38.1 | 40.0 | 60.0 | 63.5 | 90.0 | mm | in | mm | in | mm | in | mm | in | | | | | | | |
| Z06 | x | | | | ● | ● | ● | ■ | ■ | | | | 94.5 | 3.72 | 100.3 | 3.95 | 65 | 2.56 | 35.5 | 1.40 | 58.6 | 2.31 | x | | x | | |
| Z08 | x | | | | ● | ● | ● | ■ | ■ | | | | 129 | 5.08 | 131.1 | 5.16 | 65 | 2.56 | 52.6 | 2.07 | 74 | 2.91 | x | | x | | |
| Z10 | x | | | | | ● | ● | ■ | ■ | | | | 160.1 | 6.30 | 162.4 | 6.39 | 65 | 2.56 | 69.2 | 2.72 | 89.7 | 3.53 | x | | x | | |
| Z12 | x | | | | | ● | ● | ■ | ■ | | | | 191.5 | 7.54 | 193.9 | 7.63 | 65 | 2.56 | 85.7 | 3.37 | 105.5 | 4.15 | x | | x | | |
| Z13 | x | | | | | ● | | ■ | ■ | | | | 207.3 | 8.16 | 209.7 | 8.26 | 72 | 2.83 | 93.8 | 3.69 | 113.4 | 4.46 | x | | x | | |
| Z13 | | | | | | | | | | | ■ | | 207.3 | 8.16 | 209.7 | 8.26 | 150 | 5.91 | 93.8 | 3.69 | 113.4 | 4.46 | x | | | x | |
| Z16 | x | | | | | ● | | ■ | ■ | | ■ | | 254.8 | 10.03 | 257.3 | 10.13 | 200 | 7.87 | 118.2 | 4.65 | 137.1 | 5.40 | x | | | x | |

■ Molded sprocket

● Molded sprocket

■ Machined sprocket

● Machined sprocket

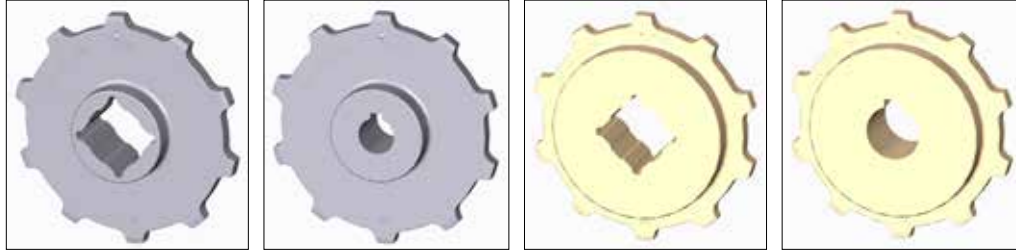

Non standard material and color: See uni Material and Color Overview.

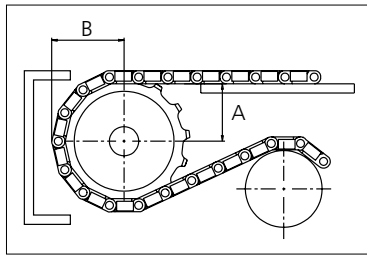

Other sprocket sizes are available upon request.
 Two-part sprocket are available upon request.
 Round bores are always delivered with keyway.
 Other bore sizes are available upon request.
 uni Retainer Rings: See uni Retainer Ring data sheet
 Width of tooth = 11.0 mm (0.43 in)
 Width of sprocket = 42.3 mm (1.67 in)

Max load per sprocket shown does not take bore size into account.
 Please also ensure that sufficient size shaft is chosen for corresponding load.

For correct sprocket position: See uni Assembly Instructions for uni OPB.
 For more detailed sprocket information, contact Customer Service.

uni OPB 8 C/160707



Solid advice
 For all your belting needs
 Local stock & service
www.ammeraalbeltech.com

Ammeraal Beltech Modular A/S
 Hjulmagervej 21
 DK-7100 Vejle

T +45 7572 3100
 F +45 7572 3348
 admin@unichains.com
 www.unichains.com

This information is subject to alteration due to continuous development. Ammeraal Beltech will not be held liable for the incorrect use of the above stated information. This information replaces previous information. All activities performed and services rendered by Ammeraal Beltech are subject to general terms and conditions of sale and delivery, as applied by its operating companies.